

## Premium Preparation 1400 mm Work Table with Upstand - Left Bowl

ITEM # \_\_\_\_\_

MODEL # \_\_\_\_\_

NAME # \_\_\_\_\_

SIS # \_\_\_\_\_

AIA # \_\_\_\_\_

**133062 (TL1410SXEN)**

Work table with left-hand bowl, upstand and worktop, 1400mm

### Short Form Specification

**Item No.** \_\_\_\_\_

The 50mm high worktop in 304 AISI stainless steel, 1,5mm in thickness, is sound-deadened and has anti-drip edges and welded corners. Under-top reinforcement in 304 AISI stainless steel. Integral rear upstand, h=100mm, with 10mm radius.

Round section legs and feet in 304 AISI stainless steel, 50mm in diameter. Height-adjustable feet (+0-50mm).

Single-pressed, sound-deadened bowl mm 400x400x200h with overflow pipe and drain hole (1"1/2). Bowl on the left hand side.

### Main Features

- The table can be ordered with the drawer of 400 mm or 600 mm (optional accessory): thanks to the design of the drawer, additional drawers can be added to the first single drawer to create chest of 2, 3 or 4 drawers based on customer's needs.
- Sturdiness, stability and reliability of table accurately tested.

### Construction

- 100 mm upstand with 10 mm radiused corner and 13 mm deep, designed to be used against a wall.
- Worktop with 50 mm high profile, in s/s Scotch Brite finishing, 15/10 in thickness with anti-drip edges and welded corners.
- Round section legs with feet in 304 AISI stainless steel, 50 mm in diameter, adjustable in height by +0/-40 mm.
- Delivered in knock-down package.
- Single-pressed bowl AISI 304 stainless steel bowl with overflow pipe and drain hole.
- Wide range of taps are available to suit every need.
- Upstand back completely covered with Stainless Steel welded profile.
- Heavy duty construction entirely in AISI 304 stainless steel to offer maximum durability.

### Optional Accessories

- Single drawer GN 1/1, 400mm PNC 855280 ☐
- Single drawer, 600mm PNC 855281 ☐
- Lower shelf for 1400mm for units PNC 855283 ☐
- Set of 4 wheels (2 with brake) d. 100mm for cupboards PNC 855288 ☐
- 3-sided underframe for 1400mm tables PNC 855291 ☐
- Additional drawer, 600mm (to set up a chest of 2, 3, 4 drawers) PNC 855295 ☐
- Additional drawer GN 1/1, 400mm (to set up a chest of 2, 3, 4 drawers) PNC 855298 ☐
- Single plastic drain syphon 1,5" PNC 855306 ☐
- Elbow operated mixer tap with spout, 3/4" single hole PNC 855322 ☐
- Elbow operated mixer tap short spout, 3/4" single hole PNC 855323 ☐
- Foot operated Mixer tap with spout & with hot&cold pedals, 3/4" PNC 855328 ☐
- Elbow operated mixer tap with spout, 3/4" single hole PNC 855374 ☐
- Elbow operated mixer tap with short spout, 3/4" single hole PNC 855375 ☐
- Single hole deck mounted mixing temperature monoblock faucet PNC 855382 ☐
- Single hole deck mounted extra robust pot filling mixing temperature faucet PNC 855383 ☐
- Single hole deck mounted mixing temperature faucet with short spout PNC 855384 ☐

**APPROVAL:** \_\_\_\_\_

- Single hole deck mounted mixing temperature pre-rinse unit PNC 855385 ☐
- Single hole deck mounted elbow operated mixing temperature faucet with pre-rinse unit PNC 855386 ☐
- Single hole deck mounted riser add-on mixing temperature faucet with pre-rinse unit PNC 855387 ☐
- Single hole deck mounted elbow operated mixing temperature faucet with short pre-rinse unit PNC 855388 ☐
- Single hole deck mounted riser add-on mixing temperature faucet with pre-rinse unit PNC 855389 ☐
- Single hole deck mounted mixing temperature faucet with pre-rinse unit PNC 855390 ☐
- Floor fastening kit for 2 square legs PNC 865386 ☐
- Single plastic drain syphon 2" for sinks PNC 895313 ☐

# Premium Preparation 1400 mm Work Table with Upstand - Left Bowl

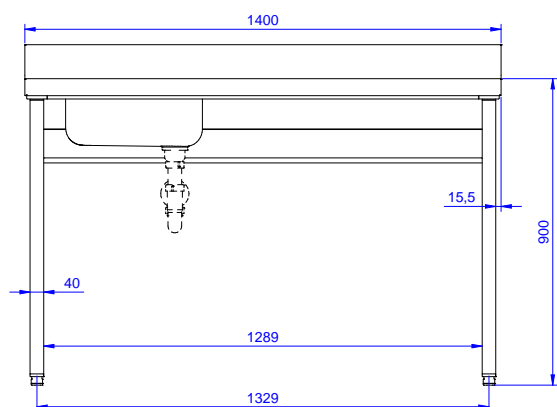
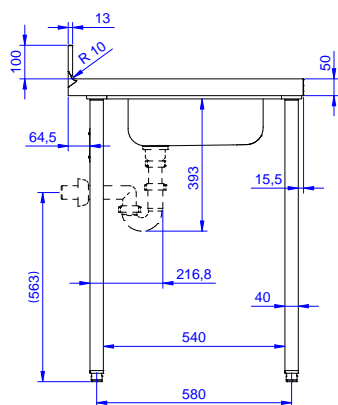
**Front**

**Side**

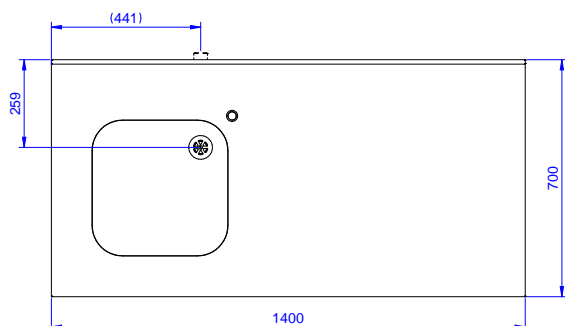
**D** = Drain

**Top**

## Key Information:

### External dimensions, Width:

**133062 (TL1410SXEN)** 1400 mm

### External dimensions, Depth:

700 mm

### External dimensions, Height:

900 mm

### Upstand Dimensions, Height:

100 mm

### Upstand Dimensions, Depth:

13 mm

### Upstand Dimensions, Radius:

R=10

### Bowls number

1

### Bowl dimensions

400x400xH250

### Worktop thickness:

50 mm

### Net weight:

45 kg

**Premium Preparation  
1400 mm Work Table with Upstand - Left Bowl**

The company reserves the right to make modifications to the products without prior notice. All information correct at time of printing.

2025.10.07